

TOP INSTALLATION HOLES

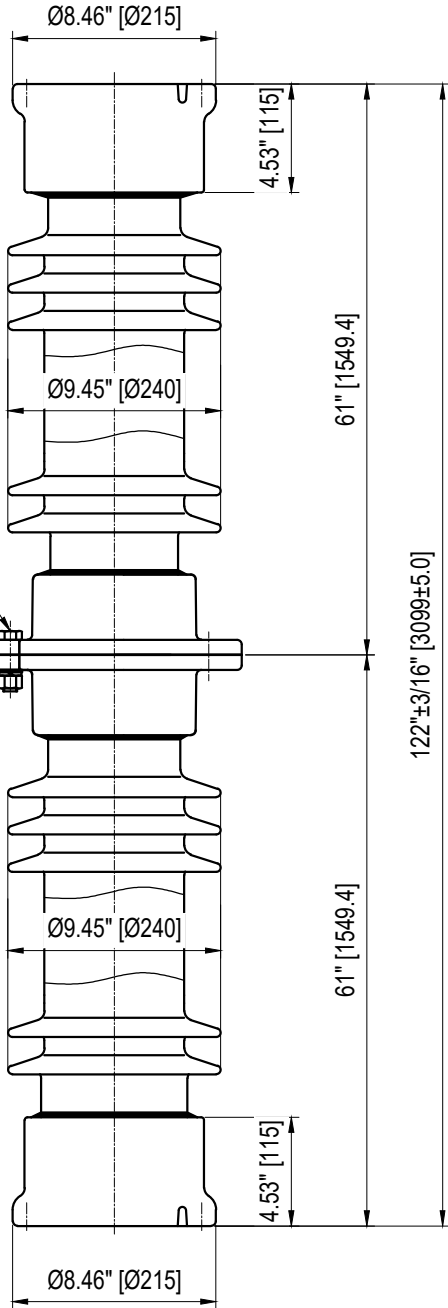

BOTTOM INSTALLATION HOLES

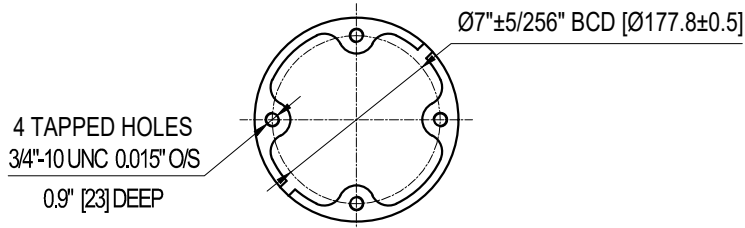
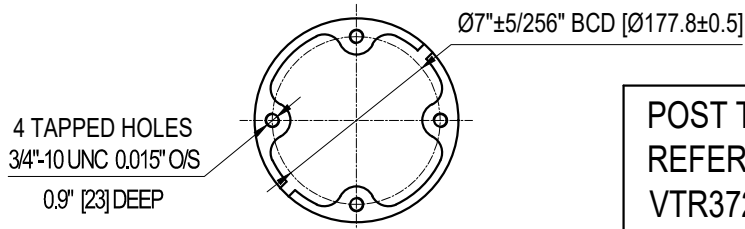

**ELECTRICAL PROPERTIES**

Critical Impulse Flashover Voltage	
Pos.:	1610 kV
Low Frequency Withstand Voltage	
Wet:	590 kV
Impulse Withstand Voltage:	1470 kV
Radio Influence Voltage Data:	
Test Voltage to Ground:	210 kV
Maximum RIV at 1000kHz:	1000 µV

**PHYSICAL PROPERTIES**

Creepage Distance:	264 in (6706 mm)
Net weight:	550 lbs (250 Kg)
Color:	Grey

**MECHANICAL PROPERTIES**

Cantilever Strength:	1750 lbs (7.8 kN)
Tension Strength:	40000 lbs (178 kN)
Torsion Strength:	120000 in·lbs (13.6 kN·m)
Compression Strength:	100000 lbs (444.5 kN)

According to Standard Specification: ANSI C 29.9

Galvanized parts as per ASTM 123

**POST TYPE INSULATOR**  
**REFERENCE: TR372**  
**VTR372SSG1**

DRAWING: TR372 VTR372SSG1 RV1



Vanguard Electric (R)  
[www.vanguardelec.com](http://www.vanguardelec.com)  
[sales@vanguardelec.com](mailto:sales@vanguardelec.com)