

TOP INSTALLATION HOLES

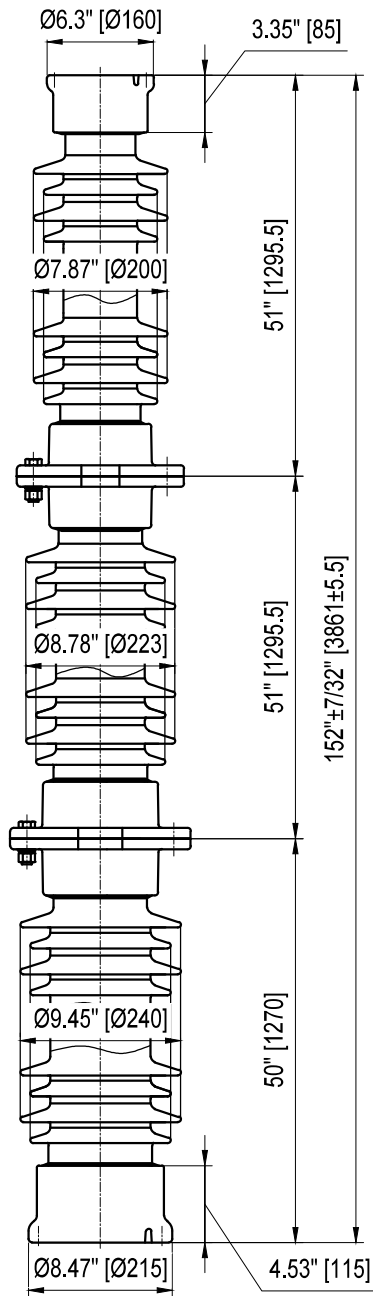

BOTTOM INSTALLATION HOLES

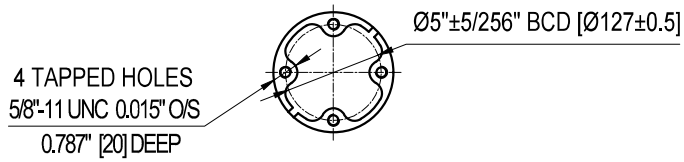
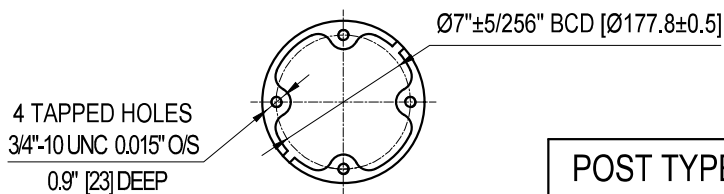

**Semi-Conductive Glazed**

ELECTRICAL PROPERTIES	
Critical Impulse Flashover Voltage	
Pos.:	2000 kV
Low Frequency Withstand Voltage	
Wet:	710 kV
Impulse Withstand Voltage:	1800 kV
Radio Influence Voltage Data:	
Test Voltage to Ground:	318 kV
Maximum RIV at 1000kHz:	2000 µV
PHYSICAL PROPERTIES	
Creepage Distance:	330 in (8382 mm)
Net weight:	510.4 lbs (232 Kg)
Color:	Grey
MECHANICAL PROPERTIES	
Cantilever Strength:	1400 lbs (6.23 kN)
Tension Strength:	20000 lbs (89 kN)
Torsion Strength:	40000 in-lbs (4.52 kN·m)
Compression Strength:	60000 lbs (267 kN)
According to Standard Specification:	ANSI C 29.9
Galvanized parts as per ASTM 123	

POST TYPE INSULATOR  
 REFERENCE: TR391  
 VTR391SSG1-SCG  
 DRAWING: TR391 VTR391SSG1-SCG RV0

Vanguard Electric (R)  
 www.vanguardelec.com  
 sales@vanguardelec.com